

EVOLVE / MEDIA

Mobile Swipe Gallery

SPEC SHEET / V04.01.0416

OVERVIEW

Mobile Swipe Gallery spawns from a 320x50* mobile banner. Upon initiation, the unit spawns a gallery that user can swipe left or right. Each image in gallery can either play video or include static image with click-through.

 [VIEW DEMO](#)

 [DOWNLOAD TEMPLATE](#)

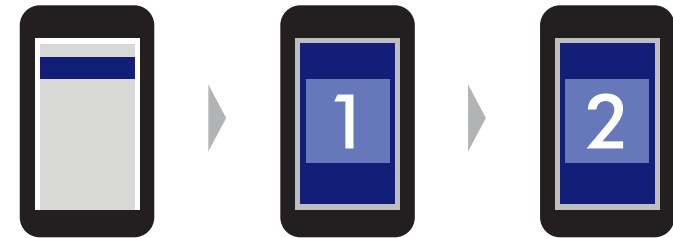

IN CONTEXT



[VIEW ON MOBILE](#)

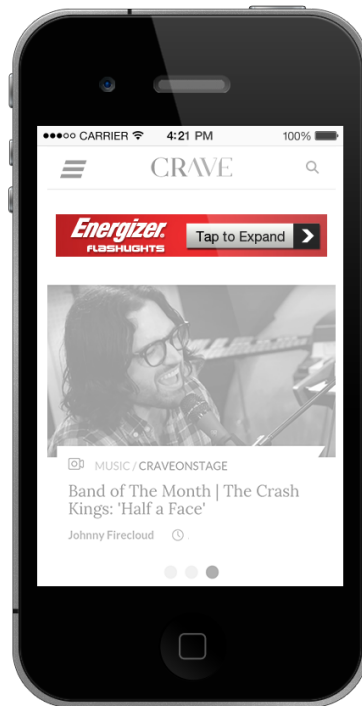

COLLAPSED STATE

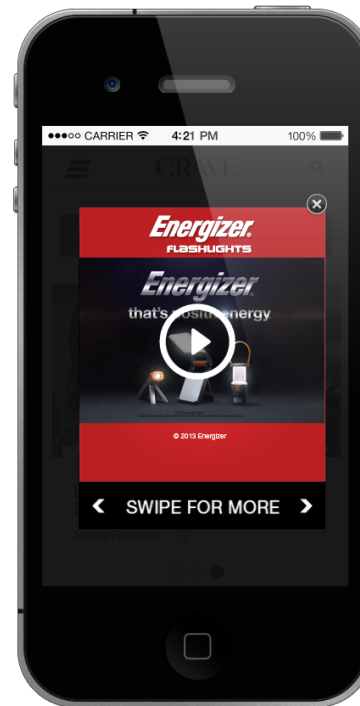

EXPANDED STATE



DETAILS & REQUIREMENTS

UNIT DIMENSIONS

COLLAPSED UNIT

- 320x50 (display size)
- 640x100 (actual size)*

EXPANDED UNIT

- 320x420 (display size)
- 640x840 (actual size)*

UNIT FILE SIZE

- 50 kB initial load
- 50 kB subsequent page loads
- 12 MB max payload

* Mobile Units are designed at double dimensions for HD-viewing on mobile devices.

ASSETS REQUIRED

HIGH-RES LAYERED SOURCE FILES

- Photoshop / Illustrator
- After Effects

FONTS

- TTF or OTF format

VIDEO SPECS

FILE SIZE

- 1 MB Video

PLAY LENGTH

- 15 seconds, preferred
- 30 seconds max.

ADDITIONAL DETAILS

- Uses touch events for engaging interactivity
- Each slide can trigger a different video or click-through
- Users can swipe up to 10 slides
- User-initiated video auto-plays sound

REPORTING METRICS

- Impressions
- Expansions
- Video plays
- Click-through
- Click-through rate
- Interactions

CREATIVE BRIEF / GUIDELINES

- Copy / Selling Points
- Release Messaging with Schedule
- Calls to Action
- Click-through URL(s)
- Legal / Rating Requirements

ALREADY-APPROVED CREATIVES

- Ad Units, Posters, etc.
- Key Art
- Product Image / Pack Shot
- Logos
- Photos / Stills

VIDEO

- 16:9 (widescreen) format, preferred
- 15-30 seconds
- 1080p resolution, preferred
- Video Codec: H.264